

LEGEND

- 1 COMMANDING GENERAL'S QUARTERS
- 2-12 OFFICERS' QUARTERS
- 13 HEAD QUARTERS, DIV. OF THE ATLANTIC AND DEPT. OF THE EAST
- 14 PRINTING OFFICE
- 15 SCHOOL HOUSE
- 16 BLACKSMITH & TINSHOP
- 17 CARPENTER & PAINTSHOP
- 18 QUARTERMASTER'S STOREHOUSE
- 19 " STABLE
- 20 " GOAL SHED
- 21 BOAT HOUSE
- 22-23 POST TRADER'S
- 24 STORE HOUSE
- 25 OFFICES OF POST QUARTERMASTER & A.C.S.
- 26 OFFICES
- 27 OFFICES, POST COMMANDER & CO.
- 28-29 OFFICERS' QUARTERS, N.Y. ARSENAL
- 30-34 ORDNANCE STORE HOUSES
- 35 STORE HOUSE
- 36 MUSEUM & OFFICE
- 37 QUARTERS
- 38 WORK SHOP
- 39 FIRE ENGINE HOUSE
- 40 BOAT HOUSE
- 41 STABLE
- 42-49 ENGINEER BUILDINGS
- 50 POWDER MAGAZINE
- 51-52 OFFICERS' QUARTERS
- 53-54 BARRACKS
- 55 MAGAZINE
- 56 POST HOSPITAL
- 57 N.C.S. & GENERAL-SERVICE CLERK'S QUARTERS
- 58 CHAPEL
- 59 QUARTERS
- 60 BAND BARRACKS
- 61 HOSPITAL STEWARD'S QUARTERS
- 62 BATH HOUSE

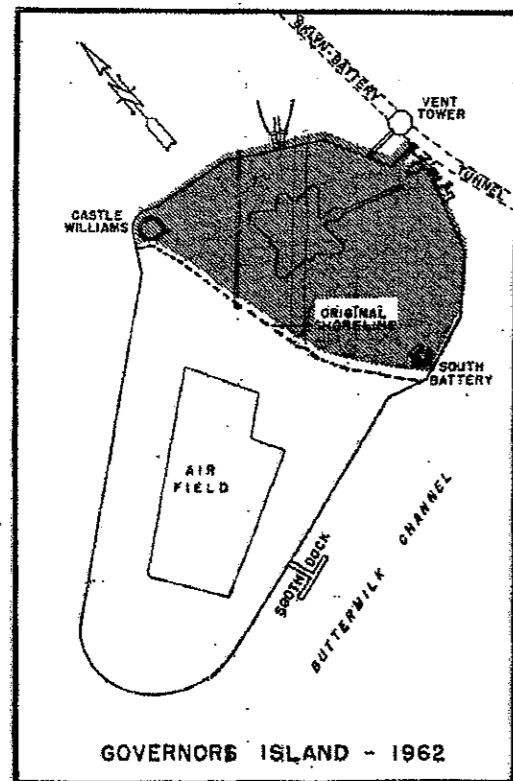

GOVERNORS ISLAND - 1962

FIRST U S ARMY ENGINEERS
MAP OF
GOVERNORS ISLAND - 1879

FROM A SURVEY BY 1ST LT E GRIFFIN, CE
& MR F N OWEN, ASST ENGR

GOVERNORS ISLAND, N.Y.

Scale in feet

Constructed from descriptions of submerged lands at Governors Island NY Conveyed to U.S. by Acts of State Legislature 1880, 1901, & 1903.

This map obtained from O.G.E. Dec 1951.

LEGEND
 This reservation comprises the wharfs at Governors Island (donated to U.S. by Act of State Legislature Feb. 15, 1880) together with submerged land contiguous to island conveyed by State Legislature in 1880, 1901 & 1903.
 Area above water 69.76 Acres (After recent filling operations)
 Present Fort begun in 1806 on site of an old fort.
 Lat. 40° 42' Long. 74° 03'.
 Elevation above sea level 0 to 20 feet.
 Total area 204.5 acres more or less.
 Metal Boundaries established in G.O. No. 4, W.P. 1903.

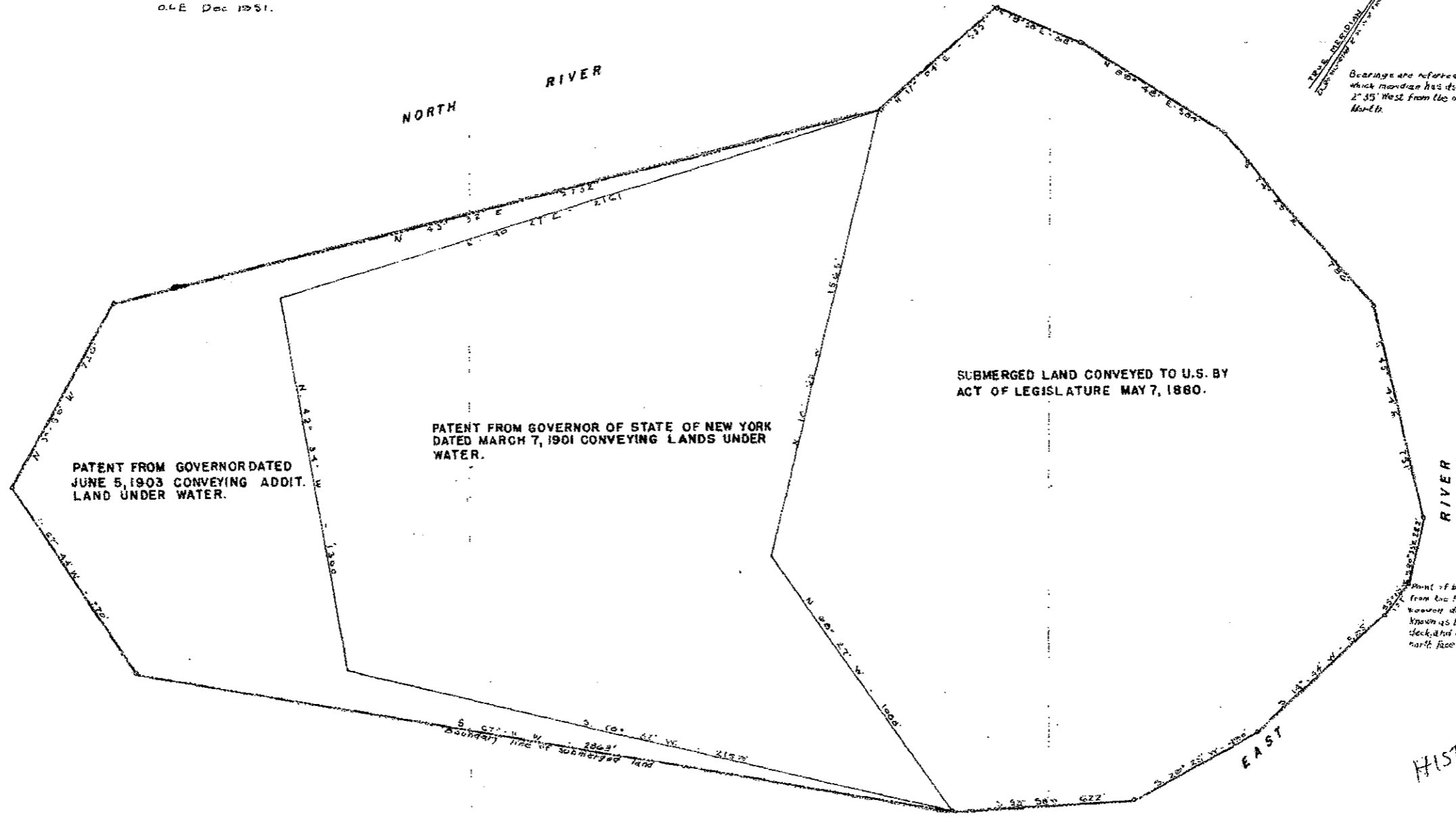
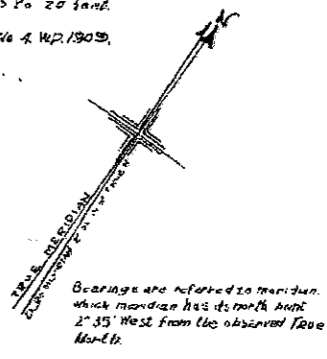

Point of beginning is 50 ft. from the head of the main wooden dock, which is known as the Quartermasters Dock, and is 2.50 with the north face of said dock.

HISTORIC FILE

FORT JAY, NEW YORK

COPYRIGHT BY THE UNITED STATES GOVERNMENT. PRINTED AT THE GOVERNMENT PRINTING OFFICE: 1951. O-501115. THIS MAP IS A REPRODUCTION OF A MAP SHOWING IN GENERAL ORDER NO. 4, U.S. DEPARTMENT OF THE ARMY, 1903.